

A high-speed racing yacht is shown from a side-on perspective, sailing on a blue sea with white-capped waves. The yacht has a dark hull and a large, light-colored sail with a complex, woven pattern. Several crew members in red gear are visible on the deck. The sky is blue with scattered white clouds. The overall scene conveys speed and performance.

Tylaska

MARINE & AEROSPACE

ENGINEERED
PERFORMANCE

WWW.TYLASKA.COM

TABLE OF CONTENTS

TRIGGER SNAP SHACKLES	P.03
SNAP SHACKLE FIDS	P.28
HALYARD SHACKLES	P.30
PLUNGER PIN SNAP SHACKLES	P.36
J-LOCK SHACKLES	P.38
PRESSLOCK	P.40
LOW FRICTION RINGS	P.42
ROPE BUSHINGS	P.44
DOGBONES	P.48
SPOOL SHACKLES	P.50
SWIVELS AND LOOSE BAILS	P.52
NORSEMAN GIBB SWAGELESS CONES	P.54
DOWNWIND HARDWARE	P.56
LIFTING HOOKS	P.59





Tylaska's Trigger Snap Shackles are world renowned as the best sailing snap shackles that money can buy. Fabricated from high strength 17-4 PH stainless steel and polished to a mirror finish, the T-Shackle is both extremely strong and highly corrosion-resistant. The T-Shackle was meticulously designed using advanced calculus to reliably release under low loads without compromising its resistance to accidental release when subject to heavy vibrations or shock loads.

The signature geometry of smooth flowing curves reduces the risk of snagging and allows the T-Shackle to easily pass over stays without fouling. Unlike other snap shackles on the market, every casting in a T-Shackle goes through Hot Isostatic Pressing ("Hipping"), a process typically reserved for jet turbine blades and other critical aerospace parts. This process reduces internal flaws giving Tylaska Trigger Snap Shackles some of the highest strength-to-weight ratios on the market and supreme reliability.

With over 25 years of performance on the most advanced cruising and racing yachts across the globe, the T-Shackle has proven its exceptional dependability and capability time and time again.

Tylaska Marine and Aerospace, 800 Flanders Rd, Mystic, CT 06355 USA

T5 | T8 | T12 | T16 | T20 | T30 | T40 | T50



EVERY SHACKLE PROOF LOADED TO WORKING LOAD LIMIT
HIGH STRENGTH 17-4 PH STAINLESS STEEL
SMOOTH SNAG RESISTANT GEOMETRY
HOT ISOSTATIC PRESSED COMPONENTS PROVIDE PEAK RELIABILITY
OPTIMIZED DESIGN WITH 25 YEARS OF FIELD-PROVEN SUCCESS

Standard Bail

Standard Bails provide ample room for attaching a line while keeping weight and overall shackle length to a minimum. Ideal for halyards and sheets.



Large Bail

Large Bails provide room for up to three additional shackles or a combination of shackles and lines. Ideal for spinnaker sheets, guys or other multi-line applications.



Clevis Bail

Clevis Bails do not require splicing and provide moveable attachments to rings, deck fittings, furlers, rolling furlers, etc.



Trigger Snap Shackle Series Quick Guide

Model	T5	T8	T12	T16	T20	T30	T40	T50
Boat Length	20-30ft	24-36ft	30-45ft	40-50ft	40-70ft	60+ ft	100+ ft	100+ ft
Length (SB)	2.94"	3.44"	4"	4.72"	5"	6.38"	9.57"	10.63"
Working Load	2500lb	4000lb	6000lb	8000lb	10000lb	15000lb	20000lb	25000lb



***WARNING:** Never use any Tylaska Trigger Snap Shackle for lifting applications. The T-Shackle is designed to be releasable under load, which presents an inherent and unacceptable risk of injury or death if a suspended load is accidentally released.

T5

Tylaska T5 Trigger Snap Shackles are perfect for small boat applications requiring high strength and low weight. Ideal for 20-30 foot boats.

- Breaking load - 5,000 lb
- 100% proof tested to max working load
- Heat treated 17-4 PH stainless steel
- Available in standard, large and clevis bail types
- Also available in black oxide and bronze finish



STANDARD BAIL **ACTUAL SIZE**



SCAN TO VIEW ONLINE





T5 SPECIFICATIONS

PART NUMBER	BAIL TYPE	A (mm)	B (mm)	C (mm)	D (mm)	E (mm)	WEIGHT (g)	MAX WORK LOAD (kg)	BREAKING LOAD (kg)
TY1005-S	STANDARD	13.5	12.7	76.7	-	-	61	1130	2270
TY1005-L	LARGE	13.5	20.6	85.6	-	-	77	1130	2270
TY1005-CM	CLEVIS (6mm PIN)	13.5	14.5	81	6	12.7	77	1130	2270
TY1005-CR	CLEVIS (1/4" PIN)	13.5	14.3	81	6.3	12.7	77	1130	2270

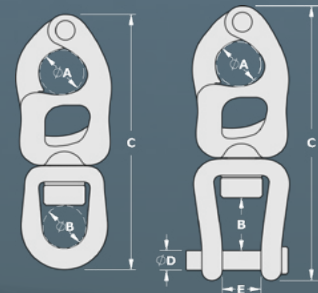

T8

Tylaska T8 Trigger Snap Shackles are perfect for medium sized boat applications requiring high strength and low weight. Ideal for 24-36 foot boats.

- Breaking load - 8,000 lb
- 100% proof tested to max working load
- Heat treated 17-4 PH stainless steel
- Available in standard, large and clevis bail types
- Also available in black oxide and bronze finish



STANDARD BAIL **ACTUAL SIZE**



SCAN TO VIEW ONLINE



T8 SPECIFICATIONS

PART NUMBER	BAIL TYPE	A (mm)	B (mm)	C (mm)	D (mm)	E (mm)	WEIGHT (g)	MAX WORK LOAD (kg)	BREAKING LOAD (kg)
TY1008-S	STANDARD	16	14.6	88.5	-	-	99	1810	3630
TY1008-L	LARGE	16	24.1	99.9	-	-	128	1810	3630
TY1008-CM	CLEVIS (6mm PIN)	16	17.3	94.1	6	13.5	119	1360	3630
TY1008-CR	CLEVIS (9/32" PIN)	16	17	94.1	7.1	13.5	122	1810	3630

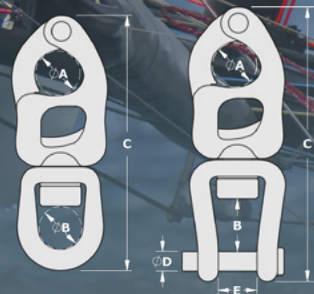

T12

Tylaska T12 Trigger Snap Shackles are perfect for medium sized boat applications requiring high strength and low weight. Ideal for 30-45 foot boats.

- Breaking load - 12,000 lb
- 100% proof tested to max working load
- Heat treated 17-4 PH stainless steel
- Available in standard, large and clevis bail types
- Also available in black oxide and bronze finish



STANDARD BAIL **ACTUAL SIZE**



SCAN TO VIEW ONLINE





T12 SPECIFICATIONS

PART NUMBER	BAIL TYPE	A (mm)	B (mm)	C (mm)	D (mm)	E (mm)	WEIGHT (g)	MAX WORK LOAD (kg)	BREAKING LOAD (kg)
TY1012-S	STANDARD	18	18.2	104	-	-	167	2720	5440
TY1012-L	LARGE	18	28.3	117	-	-	230	2720	5440
TY1012-CR	CLEVIS (8mm PIN)	18	20.5	110	7.9	16	196	2720	5440



T16

Tylaska T16 Trigger Snap Shackles are perfect for medium sized boat applications requiring high strength and low weight. Ideal for 40-50 foot boats.

- Breaking load - 16,000 lb
- 100% proof tested to max working load
- Heat treated 17-4 PH stainless steel
- Available in standard, and large bail types



SCAN TO VIEW ONLINE





T16 SPECIFICATIONS

PART NUMBER	BAIL TYPE	A (mm)	B (mm)	C (mm)	WEIGHT (g)	MAX WORK LOAD (kg)	BREAKING LOAD (kg)
TY1016-S	STANDARD	22.9	20.1	120	258	3630	7260
TY1016-L	LARGE	22.9	33.3	138	363	3630	7260



T20

Tylaska T20 Trigger Snap Shackles are perfect for medium to large boat applications requiring high strength and low weight. Ideal for 40-70 foot boats.

- Breaking load - 20,000 lb
- 100% proof tested to max working load
- Heat treated 17-4 PH stainless steel
- Available in standard, large and clevis bail types



SCAN TO VIEW ONLINE





T20 SPECIFICATIONS

PART NUMBER	BAIL TYPE	A (mm)	B (mm)	C (mm)	D (mm)	E (mm)	WEIGHT (g)	MAX WORK LOAD (kg)	BREAKING LOAD (kg)
TY1020-S	STANDARD	25.1	25.1	134	-	-	360	4540	9070
TY1020-L	LARGE	25.1	35.3	147	-	-	451	4540	9070
TY1020-CM	CLEVIS (10mm PIN)	25.1	28.9	142	10	20.3	431	4540	9070
TY1020-CR	CLEVIS (7/16" PIN)	25.1	28.7	142	11.1	20.3	434	4540	9070

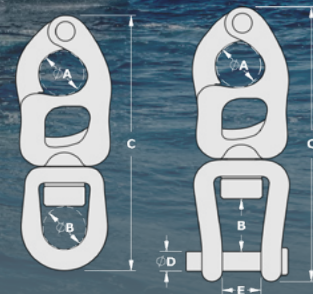

T30

Tylaska 30 Trigger Snap Shackles are perfect for large boat applications requiring high strength and low weight. Ideal for 60+ foot boats. Not For Lifting.

- Breaking load - 30,000 lb
- 100% proof tested to max working load
- Heat treated 17-4 PH stainless steel
- Available in standard, large and clevis bail types
- Optional locking pin



SCAN TO VIEW ONLINE



T30 SPECIFICATIONS

PART NUMBER	BAIL TYPE	A (mm)	B (mm)	C (mm)	D (mm)	E (mm)	WEIGHT (g)	MAX WORK LOAD (kg)	BREAKING LOAD (kg)
TY1030-S	STANDARD	31.2	30.5	166	-	-	760	6800	13610
TY1030-L	LARGE	31.2	44.8	186	-	-	989	6800	13610
TY1030-CM	CLEVIS (12MM PIN)	31.2	34.3	176	12	26.2	885	4540	13610
TY1030-CR	CLEVIS (9/16" PIN)	31.2	32.8	176	14.3	26.2	899	6800	13610



T40

Tylaska T40 Trigger Snap Shackles are designed for massive sailboats and for towing. With a breaking strength of 40,000 pounds, this shackle can handle sail loads on the largest of sailboats. The trigger is designed for a lanyard attachment for convenient remote release. A locking pin provides extra security from accidental release. Not For Lifting.

- Breaking load - 40,000 lb
- 100% proof tested to max working load
- Heat treated 17-4 PH stainless steel
- Available in standard, large and clevis bail types
- Included trigger-locking pin



SCAN TO VIEW ONLINE





T40 SPECIFICATIONS

PART NUMBER	BAIL TYPE	A (mm)	B (mm)	C (mm)	D (mm)	E (mm)	WEIGHT (kg)	MAX WORK LOAD (kg)	BREAKING LOAD (kg)
TY1040-S	STANDARD	44.5	45.5	241	-	-	2.34	9070	18140
TY1040-L	LARGE	44.5	67.8	270	-	-	3.08	9070	18140
TY1040-CR	CLEVIS (3/4" PIN)	44.5	50.8	257	19	38.1	2.87	9070	18140



T50

Tylaska T50 Trigger Snap Shackles are the largest trigger-type snap shackle ever made. They are designed for massive sailboats and for towing. With a breaking strength of 50,000 pounds, this shackle can handle sail loads on the largest of sailboats. The trigger is designed for a lanyard attachment for convenient remote release. A locking pin provides extra security from accidental release. Not For Lifting.

- Breaking load - 50,000 lb
- 100% proof tested to max working load
- Heat treated 17-4 PH stainless steel
- Available in standard, large and clevis bail types
- Included trigger-locking pin



SCAN TO VIEW ONLINE



T50 SPECIFICATIONS

PART NUMBER	BAIL TYPE	A (mm)	B (mm)	C (mm)	D (mm)	E (mm)	WEIGHT (kg)	MAX WORK LOAD (kg)	BREAKING LOAD (kg)
TY1050-S	STANDARD	49.5	50.8	294	-	-	3.2	11340	22680
TY1050-L	LARGE	49.5	75.7	301	-	-	4.15	11340	22680
TY1050-CR	CLEVIS (7/8" PIN)	49.5	57.4	288	22.2	22.2	3.95	11340	22680

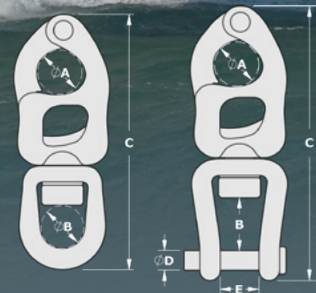

Martin Breaker Snap Shackles

The Martin Breaker variant of the T-Shackle provides an integrated Dyneema trip line that allows the shackle to be easily remotely released. When used on a spinnaker tack, the Martin Breaker can be rigged to release automatically when the tack line is eased or manually by pulling on the routed trip line. Available for the T5, T8, T12, T6, and T20 standard bail snap shackles.



Specialty Finish T-Shackles

If you're looking for the performance and reliability of the Tylaska Trigger Snap Shackle and need hardware with a classic bronze or tactical black finish we've got you covered. Tylaska's T5, T8, and T12 standard and large bail snap shackles all come with the option of either a bronze-colored PVD or black oxide finish.



SPINNAKER PEEL LINKED SHACKLES

Spinnaker Peel Linked Shackles - Tylaska trigger shackles are also available as an assembly joined together at the bails. This arrangement is ideal for temporarily holding the guy during a running spinnaker change or "peel" as it is sometimes called. Two Tylaska trigger shackles are then fitted to the linked bail to produce a "peeling strop" or "handcuffs" as they are often nicknamed. Other configurations available upon request including welded ring versions and individual linked bails.

These products are built to user-specified configurations.
Please contact info@tylaska.com for details.



TACK SHACKLE X8A

This shackle design sews into the tack of a jib in place of a sail ring, making it much easier to use than normal snap shackles and without the need for extensive lashing. Mounting lugs formed into sides of shackle allow it to be easily sewn into sail tack, firmly securing the shackle to sail to prevent shifting and twisting that occurs with regular shackles. Standard 1" webbing fits snugly into rounded lugs under load. Lanyard line or webbing can be looped through the trigger hole for "crouch free" easy release.

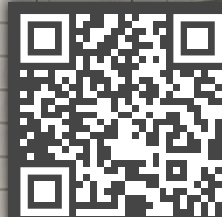

SCAN TO VIEW ONLINE

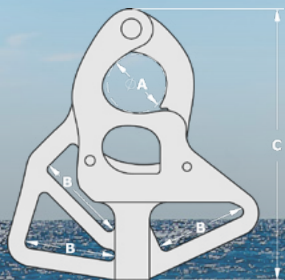

X8A SPECIFICATIONS

PART NUMBER	SHACKLE TYPE	A (mm)	B (mm)	C (mm)	WEIGHT (g)	WORKING LOAD LIMIT (KG)	BREAKING LOAD (kg)
TY1008-X8A	X8A Tack Shackle	16	24.5	73.8	97	1,810	3,630

SP SNAP SHACKLES



SCAN TO VIEW ONLINE

Tylaska's **SP Trigger Snap Shackles** are a modern spin on the vintage Sparcraft design of trigger release snap shackles. Made from the same durable 17-4PH stainless as our trigger shackles, the castings are now hipped to create a finished part similar to a forging in strength and metal consistency. While they are not designed to release under load like our newer T shackle, the SP shackle is a high quality and rugged shackle that lives up to the Tylaska name it carries. SP snap shackles do offer a larger eye compared with their T shackle counterparts. Compatible with the T5-T16 handheld fid.

SP6

- Suitable for boats up to 45ft. in length
- Weight - 0.34 lb
- Breaking strength - 12,000 lb

SP10

- Suitable for boats 45ft to 70ft. in length
- Weight - 0.68 lb
- Breaking strength - 20,000 lb

SP15

- Suitable for boats 60ft.+ in length
- Weight - 1.33 lb
- Breaking strength - 30,000 lb



SP SPECIFICATIONS

PART NUMBER	SIZE	A (mm)	B (mm)	C (mm)	Weight (g)	WORK LOAD (kg)	BREAKING STRENGTH (kg)
TY2106	SP6	24.1	17.3	104.4	152	2,720	5,440
TY2110	SP10	27.4	22.8	125.2	308	4,540	9,070
TY2115	SP15	33	24.6	154	603	6,800	13,610



LIGHT AIR SNAP SHACKLE

Tylaska has taken the venerable, tested, and optimized T12 Trigger Shackle design and reformatted it into an ultra-lightweight polycarbonate model called the LT500 Light Air Snap Shackle. The polycarbonate LT500 is identical in dimension to the Tylaska T12 snap shackle at just a fraction of the weight. As the name suggests, this shackle was designed to be used on your spinnaker sheets on very light wind days, when getting every ounce out of your light air setup helps to keep your spinnaker full and ghosting you along.

- **Robust polycarbonate construction**
- **Working Load - 250 lb**
- **Breaking Strength - 500 lb**
- **Weight - 1oz**
- **Length - 4.1"**



SCAN TO VIEW ONLINE



LIGHT AIR SNAP SHACKLE SPECIFICATIONS

PART NUMBER	A (mm)	B (mm)	C (mm)	WEIGHT (g)	WORK LOAD (kg)	BREAKING LOAD (kg)
TY1075	18.5	16.1	104	29	113	227



SNAP SHACKLE OPENING FIDS

HANDHELD FIDS

These fids are machined from solid 6061-T6 aluminum and knurled for a more secure grip. Available in sizes for T5-T50.

Front taper fits all Tylaska shackles and most other brands. Rear thru hole allows easy attachment of a lanyard or wrist leash. An indispensable tool for fast, safe release of lines under heavy load.

PLUG FIDS

Plug fids allow for remote release of trigger shackles. The fid is pushed into the trigger hole and the tapered rear of the fid allows the trigger to snap closed again and hold the fid in place. When attached to a lanyard the plug fid is ideal for avoiding the need to crawl out into risky locations or for single-handed or night sailing.

Models offered for T5-T30.

OPTION ONE
Pull to release
remotely from
the side



OPTION TWO
Pull to release
remotely from
behind



As the plug fid is
pulled, the taper
pries the trigger
open. Great
remote side
release.



Trigger is
prried open,
shackle is
released, and
fid remains
captive



T50 HAND FID

T20-T30 HAND FID

T5-T12 HAND FID

T5-T12 HAND FID TAPERED

T5 - T30 PLUG FID



CONE FIDS

The cone fid allows for remote release of the Tylaska trigger shackles. A lanyard is placed thru the center hole. The double cone fids come with a retaining screw to lock the lanyard in place. The single cone fids have a recessed area to accommodate a knot. These fids are ideal for avoiding the need to crawl out into risky locations, for single handed or night sailing.

Both fids hang from the trigger area. When the lanyard is pulled, the fids engage the trigger, releasing the shackle. The double cone fid is designed to go thru the trigger area & separate from the shackle. The single cone fid is designed to stay in the trigger area & remain with the shackle.

Models offered for T5-T30.



SCAN TO VIEW ONLINE



HALYARD SHACKLES

Tylaska's halyard shackles are machined from aluminum plate stock and hard-coat anodized to military specifications for superior strength and durability. A captive 17-4PH stainless steel pin makes for trouble-free operation.

The machined thimble surface is suitable for permanently spliced fixed halyards. Using a high strength composite sleeve bearing, Tylaska has created true 2:1 halyard shackles capable of handling the full rated load of the shackle. These are designed to fit standard sail headboards without adding any unnecessary weight. Design is optimized by Finite Element Analysis and then validated with destructive testing



SCAN TO VIEW ONLINE



HALYARD SHACKLE SERIES QUICK GUIDE

Fixed Thimble



2:1



2:1 Split



MODEL	H5	H8	H12	H20
Boat Length	20-30ft	24-36ft	30-45ft	40-70ft
Max Line Size	11mm	14mm	16mm	18mm
Working Load	2500lb	4000lb	6000lb	10000lb

H5

- Machined 6061 aluminum
- Captive stainless steel cross pin
- Recessed thread allows for full throat opening
- Hard-coat anodized for maximum coating durability
- Available with fixed thimble or 2:1 sheave



SCAN TO VIEW ONLINE



H5 SPECIFICATIONS

PART NUMBER	TYPE	A (mm)	B (mm)	C (mm)	D (mm)	E (mm)	F (mm)	Max Line Size	Weight (g)	Working Load Limit (kg)	Breaking Load (kg)
TY1405	Fixed Thimble	22	12.6	73.3	27.2	16.1	6.6	10mm	52	1,130	2,270
TY1505	2:1 with Sheave	22	12.6	74.1	27.2	16.1	6.6	10mm	61	1,130	2,270

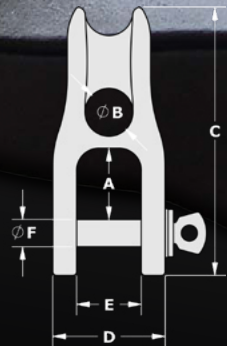

H8

- Machined 6061 aluminum
- Captive stainless steel cross pin
- Recessed thread allows for full throat opening
- Hard-coat anodized for maximum coating durability
- Available with fixed thimble or 2:1 sheave
- Split 2:1 model opens like a snatch block for easy installation and removal



SCAN TO VIEW ONLINE



H8 SPECIFICATIONS

PART NUMBER	TYPE	A (mm)	B (mm)	C (mm)	D (mm)	E (mm)	F (mm)	Max Line Size	Weight (g)	Working Load Limit [kg]	Breaking Load [kg]
TY1408	Fixed Thimble	21.2	14.3	80.2	33.5	19.3	8.1	12mm	87	1,810	3,630
TY1508	2:1 with Sheave	21.2	15.0	84.1	33.5	19.3	8.1	12mm	109	1,810	3,630
TY1508-S	Split 2:1 with Sheave	21.2	15.0	84.1	33.5	19.3	8.1	12mm	109	1,810	3,630

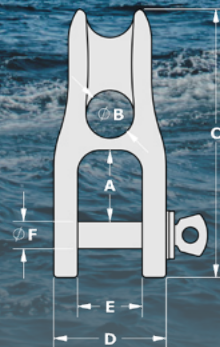

H12

- Machined 7075 aluminum
- Captive stainless steel cross pin
- Recessed thread allows for full throat opening
- Hard-coat anodized for maximum coating durability
- Available with fixed thimble or 2:1 sheave
- Split 2:1 model opens like a snatch block for easy installation and removal



H12 SPECIFICATIONS

PART NUMBER	TYPE	A (mm)	B (mm)	C (mm)	D (mm)	E (mm)	F (mm)	Max Line Size	Weight (g)	Working Load Limit (kg)	Breaking Load (kg)
TY1412	Fixed Thimble	29.0	15.9	95.0	38.1	22.4	9.7	14mm	132	2,720	5,440
TY1512	2:1 with Sheave	31.7	16.8	103.6	38.1	22.4	9.7	14mm	180	2,720	5,440
TY1512-S	Split 2:1 with Sheave	31.7	16.8	103.6	38.1	22.4	9.7	14mm	180	2,720	5,440

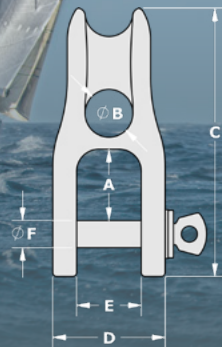

SCAN TO VIEW ONLINE

H20

- Machined 7075 aluminum
- Captive stainless steel cross pin
- Recessed thread allows for full throat opening
- Hard-coat anodized for maximum coating durability
- Available with fixed thimble or 2:1 sheave



SCAN TO VIEW ONLINE

H20 SPECIFICATIONS

PART NUMBER	TYPE	E (mm)	G (mm)	A (mm)	B (mm)	F (mm)	J (mm)	Max Line Size	Weight (g)	Working Load Limit (kg)	Breaking Load (kg)
TY1420	Fixed Thimble	38.1	19.0	122.9	46.7	25.4	12.7	18mm	296	4,540	9,070
TY1520	2:1 with Sheave	38.1	22.2	133.3	46.7	25.4	12.7	18mm	383	4,540	9,070

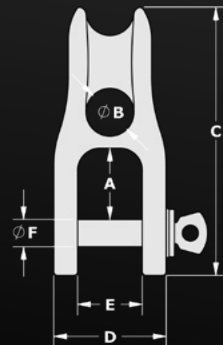

PLUNGER PIN SNAP SHACKLES

Tylaska's Plunger Pin Snap Shackles incorporate the extreme strength, outstanding corrosion resistance, and aerospace quality of Tylaska's high performance racing hardware at a price that the cruiser or casual racer will find appealing. Unlike many plunger-pin snap shackles that are prone to catching on stays, the sleek geometry of our shackle has been optimized to reduce the risk of snagging and fouling.

- High strength 17-4 PH stainless steel
- Sleek snag-resistant geometry
- Captive plunger-pin mechanism with firm spring action
- Also available with black oxide finish



SCAN TO VIEW ONLINE



PLUNGER PIN SNAP SHACKLE SPECIFICATIONS

PART NUMBER	SIZE	Bail Type	A (mm)	B (mm)	C (mm)	D (mm)	WEIGHT (g)	MAX WORK LOAD(kg)	BREAKING LOAD (kg)
TY1102	CR2	Fixed	9.7	6.6	35.1	20.3	12	455	910
TY1108-FB	CR8	Fixed	24.4	18.7	80.5	44.2	99	2000	4000
TY1108-S	CR8	Standard Swivel	24.4	13.7	92.7	44.2	128	2000	4000

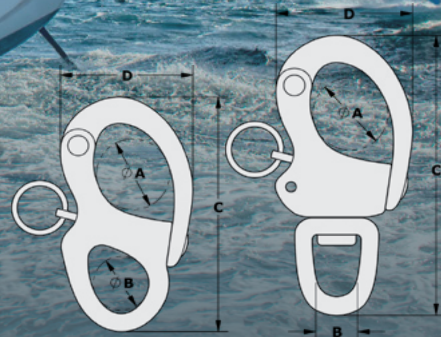

J - LOCK SHACKLES

Easily spliced onto Genoa sheets, outhauls and halyards, the low-profile Tylaska J-Lock fit fits through most Genoa blocks for fast sheet changes. The unique patented locking plunger provides the ultimate protection against accidental opening during flogging.



UNLOCKED POSITION

J-Lock opens only when the knob is rotated so that its notch is aligned with the body's tab.



LOCKED POSITION

The notch in the knob is turned away from the tab on the body and seated on the keyway shown below.



Keyway prevents knob from rotating.



SCAN TO VIEW ONLINE

J - LOCK SHACKLE SPECIFICATIONS

PART NUMBER	SIZE	A (mm)	B (mm)	C (mm)	D (mm)	E (mm)	MAX LINE SIZE	WEIGHT (g)	MAX WORK LOAD (kg)	BREAKING LOAD (KG)
TY1308	J8 Snap Shackle	15.7	11.2	53.9	26.9	10.7	10mm	54	1361	3629
TY1312	J12 Snap Shackle	17.5	12.7	61.7	30.7	12.2	12mm	82	2722	5443
TY1320	J20 Snap Shackle	21.3	16	77	38.9	16.0	14mm	167	3629	9072
TY1330	J30 Snap Shackle	25.4	19	103.1	49.3	20.3	17mm	403	6804	13608

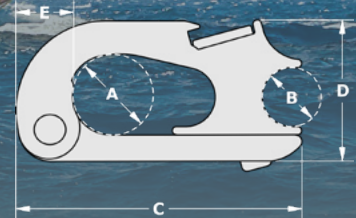

PRESSLOCK

As an alternative to Tylaska's J-Lock style shackle, the PressLock serves the same purpose with a different design. Two opposing triggers are pressed to open the shackle. Both opposing triggers must be pressed at the same time to open the shackle, which safeguards against accidental opening during flogging.



SCAN TO VIEW ONLINE

PressLock Jr

- Weight - 2.3 oz
- Max Work load - 4,650 lb
- Breaking strength - 9,300 lb
- Max line Size - 3/8"
- Suitable for 24-40ft boats

PressLock Sr

- Weight - 5.8 oz
- Max Work load - 10,000 lb
- Breaking strength - 20,000 lb
- Max Line Size - 5/8"
- Suitable for 40-80ft boats



PRESS LOCK JR ACTUAL SIZE



PRESS LOCK SR ACTUAL SIZE

PRESSLOCK SPECIFICATIONS

PART NUMBER	SIZE	A (mm)	B (mm)	C (mm)	D (mm)	E (mm)	MAX LINE SIZE	WEIGHT (g)	MAX WORK LOAD (kg)	BREAKING STRENGTH (KG)
TY2205	PressLock JR	16	12.4	60.7	25.1	5.8	11mm	65	2110	4220
TY2210	PressLock SR	19	17.3	71.1	36.8	11.9	16mm	164	4540	9070

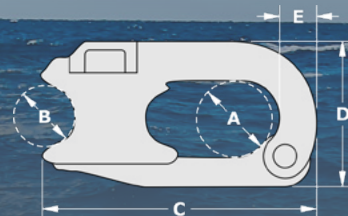

LOW FRICTION RINGS

Tylaska Low Friction Rings are lighter and smaller than a conventional pulley block and have become a popular alternative for many applications where traditional blocks once ruled. Instead of rolling on a pulley sheave, the active line merely slides on the inside smooth surface of the ring. Another line is spliced around the ring to attach to a fixed point. This attachment line is sometimes made as a loop that can be luggage tagged onto a pad eye or the toe rail. Frictional losses are a non-factor in most low speed low deflection applications, especially when using low friction lines such as dyneema. In addition to being lighter and less expensive than conventional blocks, ring ferrules are also far less prone to failure as they have no moving parts to wear or need servicing.



SCAN TO VIEW ONLINE



LOW FRICTION RING SPECIFICATIONS

PART NUMBER	SIZE	A (mm)	B (mm)	C (mm)	D (mm)	WEIGHT (g)	MAX LINE SIZE (MM)	MIN. BREAKING STRENGTH (KN)*
TY2603	FR3	4.8	3.3	11.9	5.1	1	3	3.5
TY2604	FR4	6.4	4.3	15.7	6.4	1	4	8
TY2604-SS	FR4 (Stainless Steel)	6.4	4.3	15.7	6.4	4	4	15
TY2605	FR5	7.9	5.6	20	8.1	2	5	9
TY2606	FR6	9.7	6.6	24.1	9.7	4	6	16
TY2606-L	FR6L	12.7	6.6	27.9	9.7	6	6	9
TY2607	FR7	11.2	7.6	27.9	11.2	7	7	19
TY2608	FR8	12.7	8.9	31.8	12.7	10	8	22
TY2610	FR10	16	10.9	40.1	16	21	10	36
TY2612	FR12	19.1	13.2	48	19.3	35	12	40
TY2614	FR14	22.1	15.2	56.1	22.4	55	14	45
TY2618	FR18	25.4	18.3	63.5	26.2	85	18	72
TY2622	FR22	31.8	22.1	80	32	161	22	72
TY2626	FR26	38.1	26.4	96	37.9	283	26	110



*MBS rated as minimum deformation load, or the load at which permanent deformation of the ring begins.

ROPE BUSHINGS

Tylaska's line of Rope Bushings provide a durable and low friction solution for passing lines and sheets through decks, bulkheads, and other surfaces. Just like Tylaska's popular line of low friction rings, Rope Bushings are precision machined from 6061 aluminum and hard coat anodized to military specifications, maximizing durability and wear resistance. A large smooth radius at the mouth of the bushing minimizes line friction. Available in a single piece cut-to-length variation, as well as a threaded two-piece assembly that screws together allowing use in a wide variety of applications.



SCAN TO VIEW ONLINE

SINGLE PIECE ROPE BUSHINGS

- Perfect solution for running rope through decks and bulkheads
- 6061 aluminum with highly durable hard coat anodized finish
- Large entry radius minimizes line friction
- Easy to install cut-to-length design fits any deck thickness up to 30mm



SCAN TO VIEW ONLINE

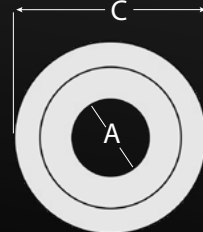
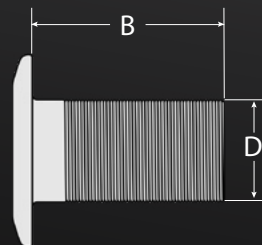

SPECIFICATIONS

PART NUMBER	DESCRIPTION	A (mm)	B (mm)	C (mm)	D (mm)	WEIGHT (g)
TY2008	RB8-S	8	30	26	12	3.2
TY2810	RB10-S	10	30	28	14	8.9
TY2812	RB12-S	12	30	30	16	10.2
TY2814	RB14-S	14	30	32	18	11.5

RB-10 | 12 | 16

- Perfect solution for running line through decks and bulkheads
- 6061 aluminum with highly durable hardcoat anodized finish
- Large entry radius minimizes rope friction
- Easy to install two-piece threaded design
- Fits 10-50mm thick decks
- 10-16mm through-hole



RB-10 SPECIFICATIONS

PART NUMBER	A (mm)	B (mm)	C (mm)	D (mm)	E (mm)	WEIGHT (g)
TY2810-12	10	10-12	32	16	28	11
TY2810-16	10	12-16	32	16	28	11.6
TY2810-22	10	12-16	32	16	28	12.8
TY2810-30	10	22-30	32	16	28	14.7
TY2810-50	10	30-50	32	16	28	17

RB-12 SPECIFICATIONS

PART NUMBER	A (mm)	B (mm)	C (mm)	D (mm)	E (mm)	WEIGHT (g)
TY2812-12	12	10-12	38	20	34	19.8
TY2812-16	12	12-16	38	20	34	20.8
TY2812-22	12	12-16	38	20	34	22.8
TY2812-30	12	22-30	38	20	34	25.8
TY2812-50	12	30-50	38	20	34	29.9

RB-16 SPECIFICATIONS

PART NUMBER	A (mm)	B (mm)	C (mm)	D (mm)	E (mm)	WEIGHT (g)
TY2816-12	16	10-12	47	24	44	33.8
TY2816-16	16	12-16	47	24	44	35
TY2816-22	16	12-16	47	24	44	37.6
TY2816-30	16	22-30	47	24	44	41.4
TY2816-50	16	30-50	47	24	44	46.4



SCAN TO VIEW ONLINE

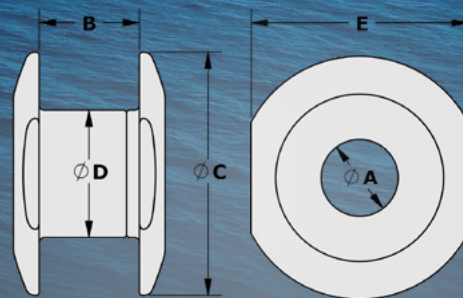

DOGBONES

A Dogbone is essentially a short structural rod that can be attached to the end of a line and used like a button or toggle to make a connection to another line, grommet or deck fitting. The tapered middle and symmetric ends make the part look like a bone, hence the name "Dogbone."

Tylaska Dogbones are available in eight different sizes, with each size available in either aluminum or 17-4PH stainless depending upon the strength requirements. The main feature of the Tylaska Dogbone design is its unique patented tapered design with a grooved texture that grabs onto the line and prevents slippage. Tylaska offers Dogbone sizes from DB6 through DB24 cover an extreme range of working loads and line sizes that no other single manufacturer provides.



DOGBONE SPECIFICATIONS

PART NUMBER	SIZE	Material	A (mm)	B (mm)	C (mm)	Line Size (mm)	Weight (g)	Breaking Load (kg)
TY2506	DB6	Aluminum	24	6	4.5	3	1	600
TY2506-SS	DB6	Stainless Steel	24	6	4.5	3	3	1,300
TY2508	DB8	Aluminum	32	8	6	4	3	1,100
TY2508-SS	DB8	Stainless Steel	32	8	6	4	9	2,300
TY2510	DB10	Aluminum	40	10	7	6	6	1,900
TY2510-SS	DB10	Stainless Steel	40	10	7	6	17	4,100
TY2512	DB12	Aluminum	48	12	8.5	7	11	2,800
TY2512-SS	DB12	Stainless Steel	48	12	8.5	7	28	5,900
TY2514	DB14	Aluminum	56	14	11	8	17	3,800
TY2514-SS	DB14	Stainless Steel	56	14	11	8	45	8,200
TY2516	DB16	Aluminum	64	16	12	10	26	5,000
TY2516-SS	DB16	Stainless Steel	64	16	12	10	68	10,400
TY2518	DB18	Aluminum	72	18	12.5	12	34	6,400
TY2518-SS	DB18	Stainless Steel	72	18	12.5	12	96	13,600
TY2524-SS	DB24	Stainless Steel	96	24	17.5	16	249	22,700

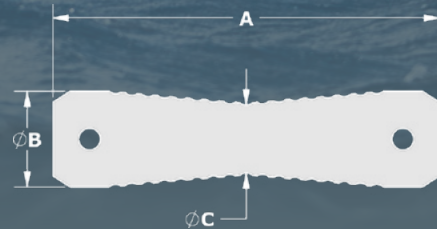

SPOOL SHACKLES

Tylaska's **Spool Shackle** gives a new option to the basic knot. Unlike a knot however, spool shackles will not jam up and remains easy to fasten and unfasten even after loading up to the tensile strength of the line.

The S-Series Spool Shackle is machined from high-strength aluminum. The P4 version of the Spool Shackle is made of high-impact polycarbonate. The key to spool shackles is that the line itself supplies the strength while the shackle simply redirects the force.

Spool Shackles works well both with conventional and modern lines, all that is needed is a looped end. A retaining pin allows for the shackle to be removed or transferred to other lines. An optional "O" ring slides over the line to provide a secondary "lock" against loosening during the most severe flogging situations.

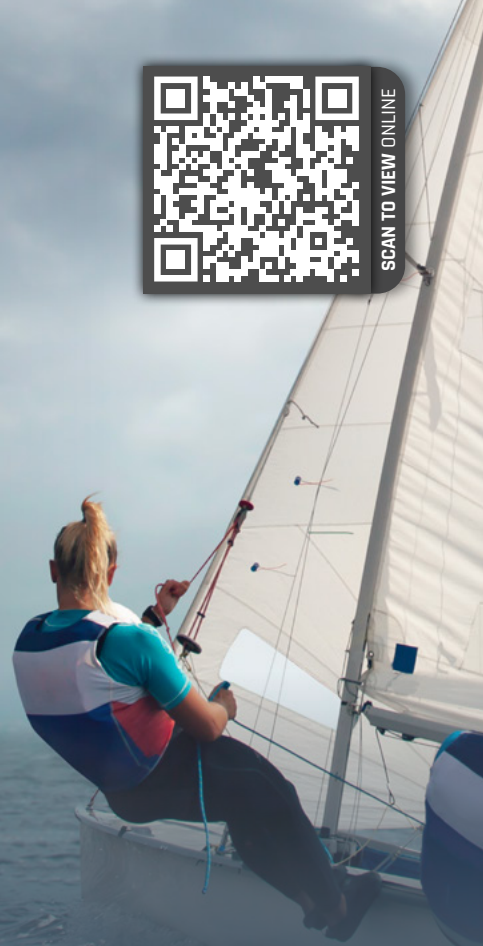

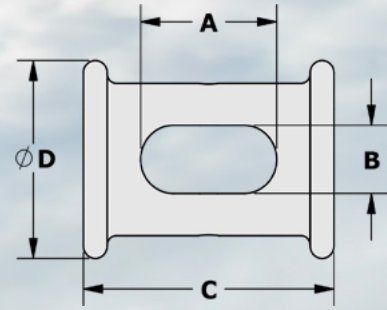

SPOOL SHACKLE SPECIFICATIONS

PART NUMBER	DESCRIPTION	A (mm)	B (mm)	C (mm)	D (mm)	Line Size (mm)	Weight (g)	Working Load Limit (kg)	Breaking Load (kg)
TY2402	S2	9.9	4.6	17	13.5	3mm	3	450	910
TY2403	S3	13.2	6.1	23.6	19.1	3-4mm	9	680	2000
TY2404	P4 (Polycarbonate)	23.1	11.2	39.6	33.8	8-10mm	23	1000	2000
TY2405	S5	14.5	7.1	26.9	22.9	5mm	14	1130	2270
TY2408	S8	23.1	8.6	33.3	25.4	6mm	20	1810	3630
TY2412	S12	23.1	11.2	39.6	33.8	8-10mm	43	2720	5440
TY2420	S20	29.5	14.2	50.5	43.4	10-11mm	85	4540	9070
TY2430	S30	45.5	20.6	74.7	63.2	12-18mm	264	6800	13600



LOOSE BAILS AND SWIVELS

Standard Bails

Standard bails provide ample room for attaching a line while keeping weight and overall shackle length to a minimum. Ideal for halyards and sheets.



Large Bails

Large bails provide room for up to three additional shackles or a combination of shackles and lines. Ideal for spinnaker sheets, guys or other multi-line applications.



Clevis Bails

Clevis bails do not require splicing and provide movable attachments to rings, deck fittings, furlers, rolling furlers, etc. Ideal for many uses.



SCAN TO VIEW ONLINE



CANVAS TOOLS

The Tylaska button die and punch make easy work of installing turn button type fasteners or snaps. The precisely spaced dual cavities allow two buttons or eyelets to be set at once. This eliminates the uneven or creased settings caused by setting each button individually.

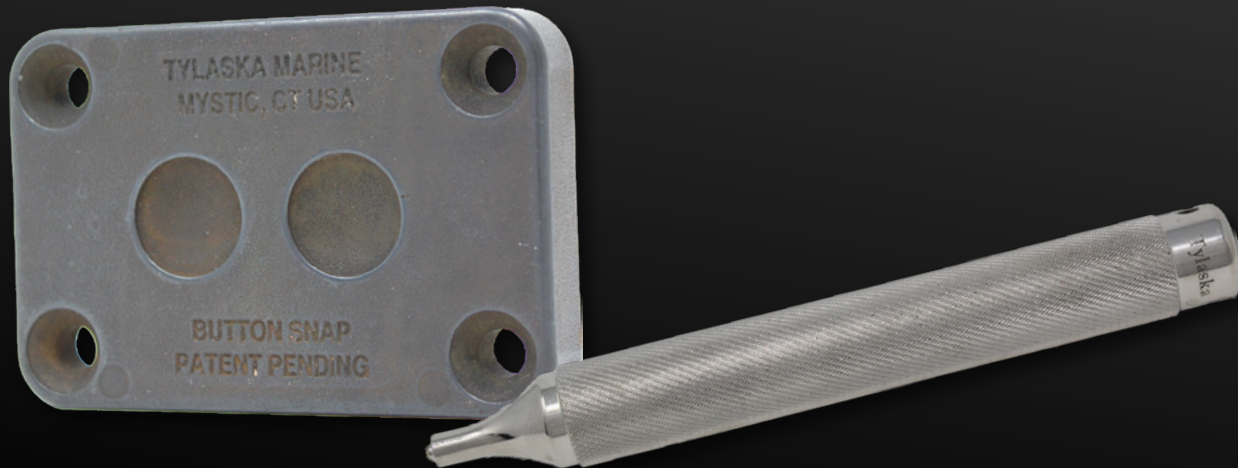

Tylaska

NORSEMAN-GIBB CONES

Tylaska Marine & Aerospace is producing replacement swageless cones according to the original Navtec Norseman-Gibb drawings.

These cones can be used as direct replacements for the legacy swageless fittings still in use. The replacement cones are made in the USA to the exact specs of the original prints with the same dimensions, tolerances and materials. Available in sizes to fit 4-14mm (5/32"- 9/16") wire rope.



SCAN TO VIEW ONLINE



DOWNWIND FITTINGS AND POLE ENDS

Spinnaker Pole Pin and Mounting Bracket Assemble

- 4 total components Mast Mount, Stud Pin, Toggle, and Pole Pin
all parts are available separately
- Mast Mount can be utilized individually for a spinnaker pole mount or as a pair for a reaching strut.
- Suitable for yachts 40-80 ft



Inboard Pole End "Stubby"

- Machined from 6061 aluminum
- Hard-coat anodizing for superior durability
- Fitting pairs with 4 inch outboard pole ends such as the Intrepid II
- CR4 is suitable for yachts 40 to 80 ft



DOWNWIND FITTINGS AND POLE ENDS

Tylaska's Intrepid II fitting's life began as a design for the 12-Meter Intrepid. This simple and efficient design has undergone refinements and is still competing at the highest levels of class racing. It is the standard pole end for all IACC yachts. Its unique trigger and latch mechanism locks open until the incoming spinnaker sheet trips the trigger, snapping the latch shut.

The Intrepid is available in 2 variants, the original Intrepid II, and the Intrepid II XD. With the original being designed for cylindrical spinnaker poles and the XD intended for rectangular box section spinnaker poles.



Intrepid II XD



Intrepid II



Tylaska

SS10

PLUNGER PIN SNAP SHACKLE

Tylaska's line of SS plunger pin style shackles were developed based on the original tried-and-true Sparcraft SS20 design.

The SS10 is NOT approved for lifting applications.

- Breaking strength - 20,000 lb
- Work load - 10,000 lb
- Weight - 1.56 lb
- Length - 4.50 in.
- Heat treated 17-4 PH stainless steel



SCAN TO VIEW ONLINE



SS10 SPECIFICATIONS

PART NUMBER	DESCRIPTION	A (mm)	B (mm)	C (mm)	D (mm)	E (mm)	F (mm)	G (mm)	H (mm)	WEIGHT (kg)	WORK LOAD (kg)	BREAKING LOAD (KG)
TY2010	SS10	23.1	111.1	13.5	54.4	13.5	16.4	23.7	27.7	0.71	27.7	9072

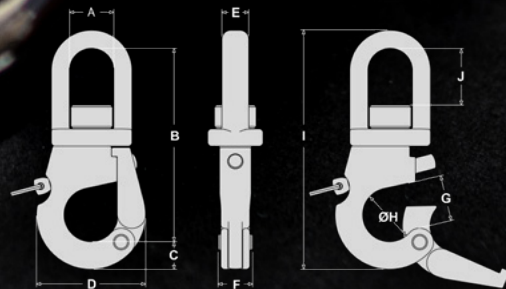

SS20L

LIFTING HOOK

Tylaska's SS series lifting hooks are CE marked and feature highly polished 17-4 PH stainless steel components and a robust plunger pin latch design. They are the perfect solution for applications where the elegance of smooth, polished stainless steel is needed in addition to industrial strength and reliability. The SS20L hook is the result of a thorough overhaul of the design and manufacturing process of the classic SS20 sailing shackle. Available in standard or clevis bails. **Approved for overhead lifting.**

- CE Marked Lifting Accessory
- WLL 2T
- Weight - 2.25 lb
- Length - 6.1 in.



SCAN TO VIEW ONLINE

SS20L SPECIFICATIONS

PART NUMBER	DESCRIPTION	A (mm)	B (mm)	C (mm)	D (mm)	E (mm)	F (mm)	G (mm)	H (mm)	WEIGHT (kg)	WORK LOAD LIMIT (metric tonnes)
TY2020L-S	SS20L Standard Bail	30	132.6	18.5	74.7	18.8	24.6	31.8	33	1.1	2
TY2020L-C	SS20L Clevis Bail-C	30	124.2	18.5	74.7	17.3	24.6	31.8	33	1.2	2



SS40L

LIFTING HOOK

Tylaska's SS series lifting hooks are CE marked and feature highly polished 17-4 PH stainless steel components and a robust plunger pin latch design. They are the perfect solution for applications where the elegance of smooth, polished stainless steel is needed in addition to industrial strength and reliability. The SS40L hook is the result of a thorough overhaul of the design and manufacturing process of the classic SS20 sailing shackle.

Approved for overhead lifting.

- CE Marked Lifting Accessory
- WLL 5T
- Weight - 8.9 lb
- Length - 9.7 in.



SCAN TO VIEW ONLINE

SS40L SPECIFICATIONS

PART NUMBER	DESCRIPTION	A (mm)	B (mm)	C (mm)	D (mm)	E (mm)	F (mm)	G (mm)	H (mm)	WEIGHT (kg)	WORK LOAD LIMIT (kg)
TY2040L-S	SS40L	47.2	228.1	30.5	117	29.2	35.6	50.3	57.2	4	5

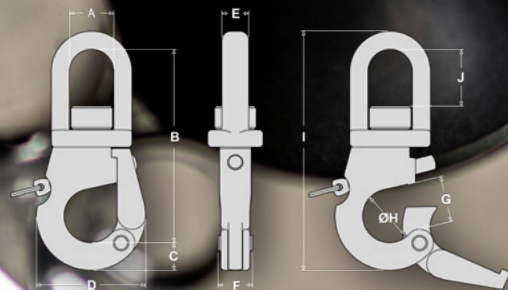

LH SELF LOCKING LIFTING HOOK

Tylaska's LH10 self-locking hook is a forged stainless steel CE marked lifting hook that meets the requirements laid out by the European Commission's machinery directive to be safely used as a lifting accessory. The LH10 is based on a standardized design and is equivalent in size and strength to existing size 10 grade 10 alloy steel self-locking hooks. Unlike existing self-locking hooks, the LH10 is constructed entirely from stainless steel and is designed to withstand harsh marine environments where regular alloy steel hooks inevitably rust and seize up.

Approved for overhead lifting.

- Fully traceable forged 17-4 PH stainless steel hook and latch.
- 100% stainless steel components
- Suitable for use with Grade 80 and Grade 100 chain.
- 27% stronger than equivalent size grade 8 hooks.
- Available in polished stainless steel or yellow powder coated finish.
- Fully replaceable locking mechanism.



SCAN TO VIEW ONLINE

LIFTING HOOK SPECIFICATIONS

PART NUMBER	DESCRIPTION	A (mm)	B (mm)	C (mm)	D (mm)	E (mm)	F (mm)	G (mm)	H (mm)	WEIGHT (kg)	WORK LOAD LIMIT (kg)
TY5010-E	LH10	32	166	33	109	14	28	44	53.3	1.7	4000

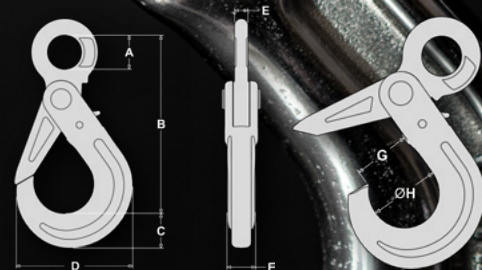

Tylaska

MARINE & AEROSPACE

Tylaska Marine & Aerospace is a premium manufacturer of highly finished specialty hardware used in the marine, industrial and aerospace fields.

The original Tylaska trigger-snap shackle evolved from a need for a reliable and robust quick release mechanism for detaching towed gliders from behind power boats. That design quickly transformed into its present configuration, a design now popular across high end inshore and offshore racing programs around the world. Building on that strong legacy, Tylaska now produces a full line of premium quality hardware for every use case. Our products are the gold standard, from weekend warriors all the way to Cup racing.

Tylaska pursues an uncommon product mission. Every component we produce is made to a standard, not a price, and that mantra shines through in all of our production and testing methods. This includes load testing and hand inspecting every single piece of hardware we produce. All of our components are designed, assembled, and tested at our facility in Mystic, Connecticut by Tylaska's team of dedicated staff.

Tylaska Marine and Aerospace, 800 Flanders Rd, Mystic, CT 06355 USA







Tylaska
MARINE & AEROSPACE

COMING SOON
NEW SS80L

8 Metric Ton Working Load Limit
Approved for overhead lifting



(860) 572-8440 INFO@TYLASKA.COM WWW.TYLASKA.COM

800 FLANDERS ROAD, MYSTIC, CONNECTICUT 06355 USA



SCAN TO VIEW ONLINE